

CARCASE SPECIFICATION

Our carcasses are supplied fully rigid built up and are manufactured in using glue and dowel construction techniques the same as those employed by the leading kitchen manufacturers in Europe. Doors and drawer fronts are professionally mounted to the carcasses when using our standard plus, gold and platinum services. (see service and delivery terms). The diy enthusiast can save money by using our standard service and mount the doors themselves using our professional hinge jig boring tool that can be either purchased or rented online.

The carcasses are manufactured using Egger 18mm high density melamine faced chipboard with 8mm melamine faced chipboard backs to both wall and base units. All of the carcass front edges are lipped with a durable 2mm PVC edging material to match the various carcass colour selected. All other exposed edges are lipped with 0.4 edging tape.

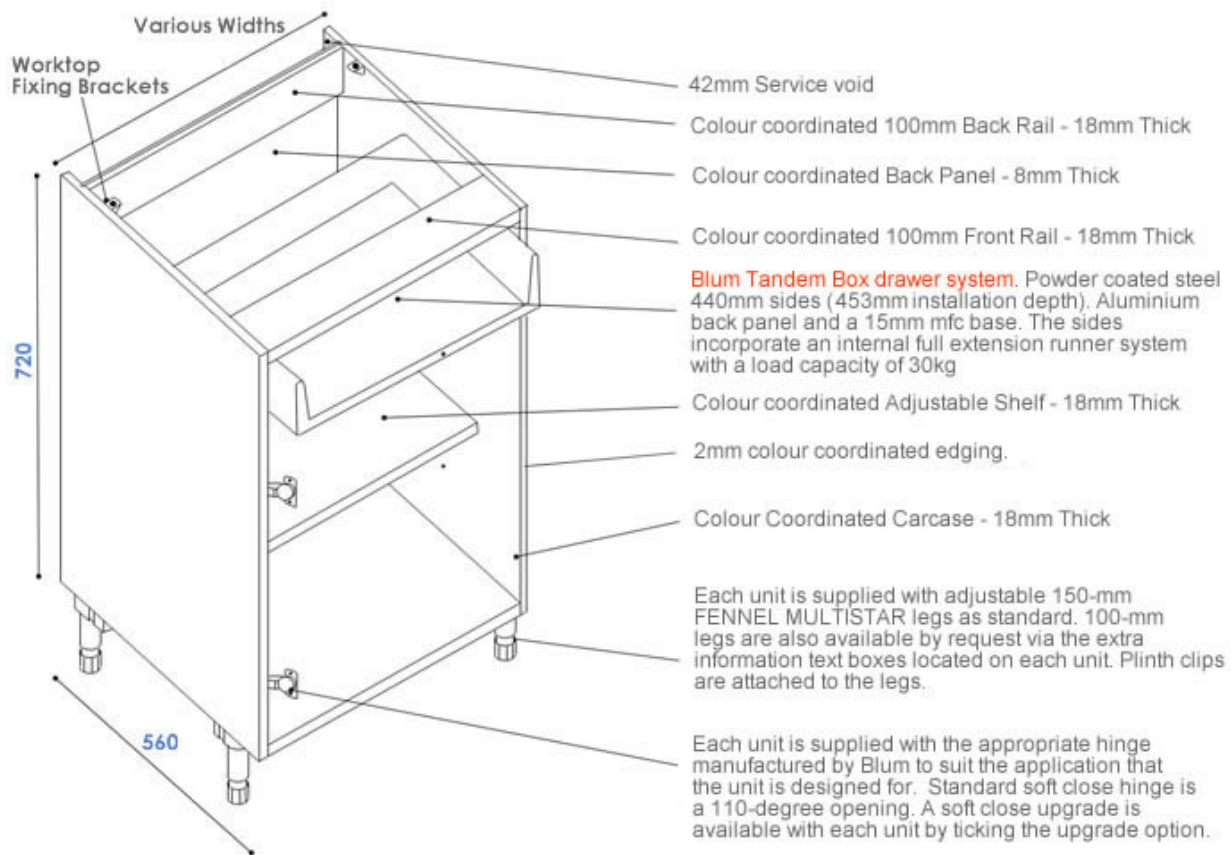

Base units are drilled to provide 3 adjustable shelf positions.

Three way adjustable concealed hanging brackets are fitted to the wall units. Each pair of brackets can carry up to 70 kilograms and conforms to DIN68840. Wall plates are supplied as standard.

All wall units are drilled to provide adjustable shelf positioning. 570 high units have one shelf, 720 and 900 high units have 2, cover caps in white, beige or brown are supplied for the unused drillings. Wall units are 300mm deep excluding the door.

We can offer flexibility to the carcass specifications - units can be increased and reduced in depth. (limits apply) This can be requested when ordering the units online.

With our units you always have the option of having your units delivered in a standard configuration. This can be requested when ordering the units online.

Where units are shown with drawer and pan drawer boxes they are supplied fitted in to the units. These are full extension Hettich Innotech Double skinned metal drawers. Pan drawers have a gallery rail supplied to increase the height of the drawer.

We use the BLUM TANDEMBOX full extension drawer system as standard. Powder coated steel, 470mm sides (485mm installation depth), Aluminium back panel and a 15mm mfc base.

BLUM Soft close system can be built into the runner with a load capacity of 50kg. Soft close drawer boxes can be requested for £5 per drawer when ordering the units online



Each unit is supplied with adjustable 150-mm FENNEL MULTISTAR legs as standard with 100-mm legs available as an option. Both of the leg options have a minus adjustment of 10 mm and a plus adjustment of 20 mm. The legs fold into the foot for transport as can be seen in the following illustration. Each unit is supplied with 2 adjustable plinth clips clipped on to the front 2 legs. The plinth clips fit over the top of the plinth and have a lip that fits over the top of the plinth. With every order 6 self-adhesive clips are sent out for the plinth returns.

Each unit is supplied with the appropriate hinge manufactured by Blum to suit the application that the unit is designed for. Standard hinges are 110 degree opening all steel 3 way adjustable hinges with an inline clip system base-plate. Soft close hinges can be requested for £2.50 per door when ordering the units online.



Dimensions to suit 570mm high wall units

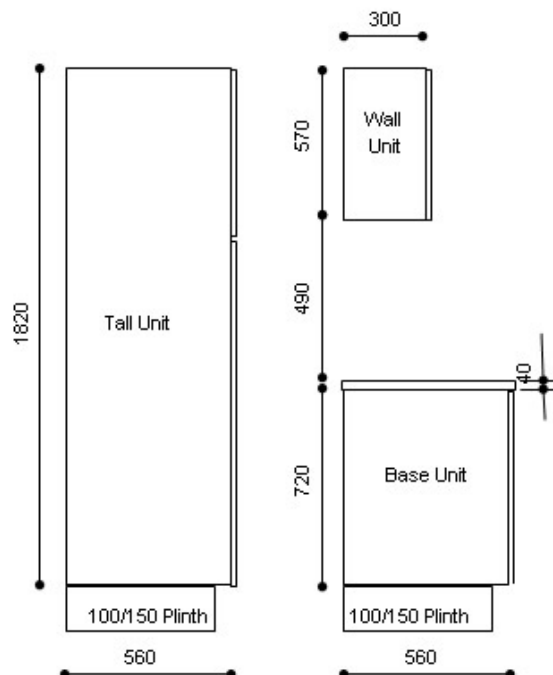

Dimensions to suit 720mm high wall units

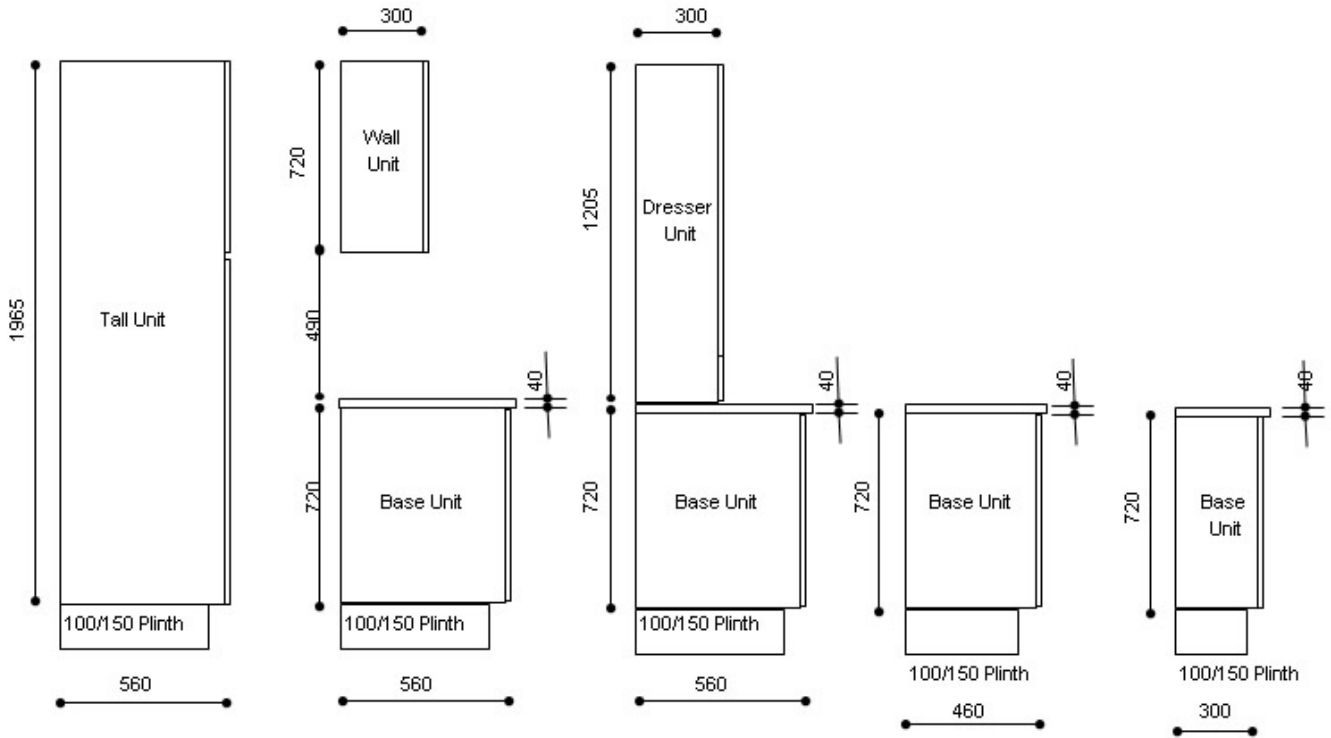

Dimensions to suit 900mm high wall units

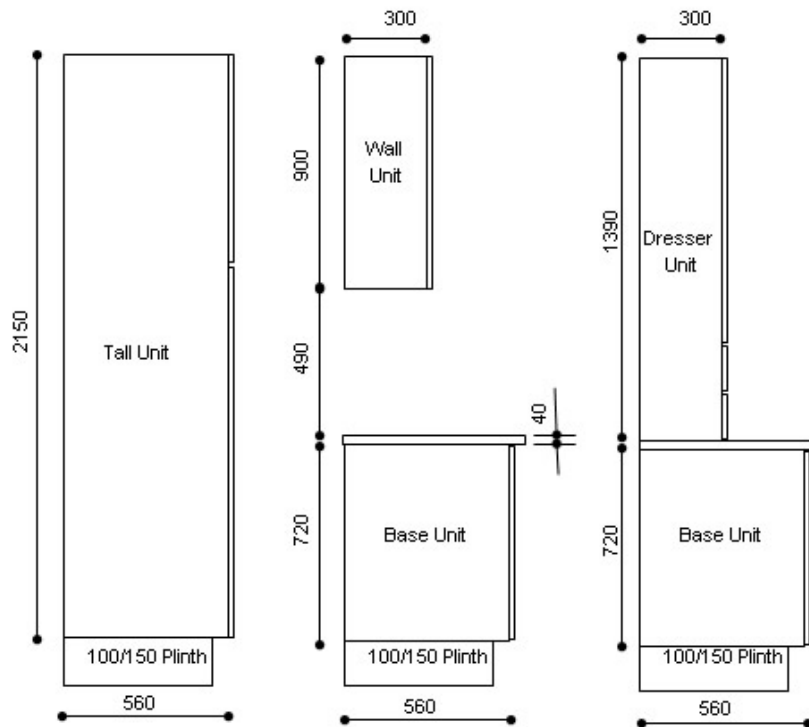

Dimensions to suit midheight and display units

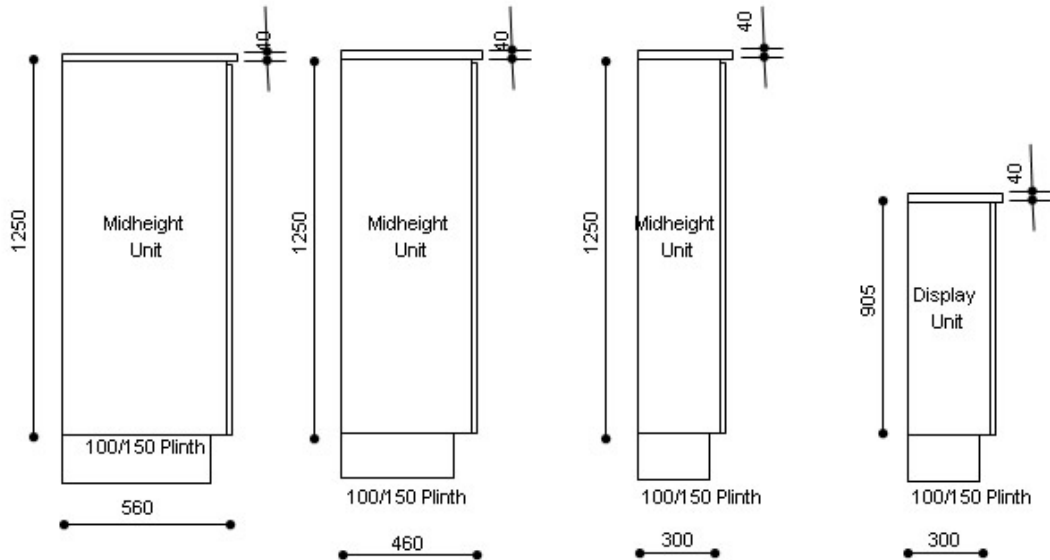

CORNER UNITS SPECIFICATION

Note: This cabinet in itself is a variable planning dimension. Designed to be positioned in the corner of the room in such a way as to prevent the requirement of fillers between the other cabinets in the run.

Note: This cabinet in itself is a variable planning dimension. Designed to be positioned in the corner of the room in such a way as to prevent the requirement of fillers between the other cabinets in the run.

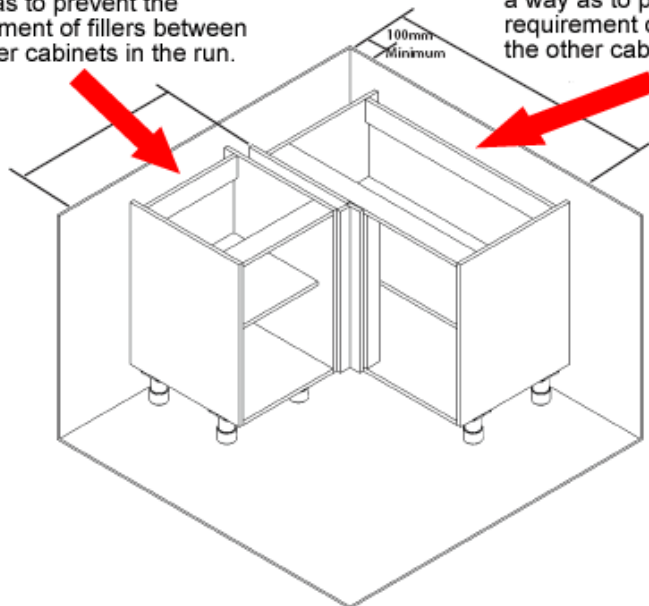

When fitting a base corner arrangement please use the following instruction:

1. Position corner blank base unit a minimum of 100mm from the wall allowing for depth of handle from door as selected
2. If using a corner fillet remove and refit blanking panel to allow the fillet to be fitted in position as shown. Refit the blanking panel butting it up to the back edge of the fillet and trim if required
3. Fit the adjoining corner cabinet into position as shown allowing a minimum gap between the two cabinets (excluding the blanking panel) again remembering to allow for depth of handle selected

Note: Blanking panel on all base cabinets is 500mm wide

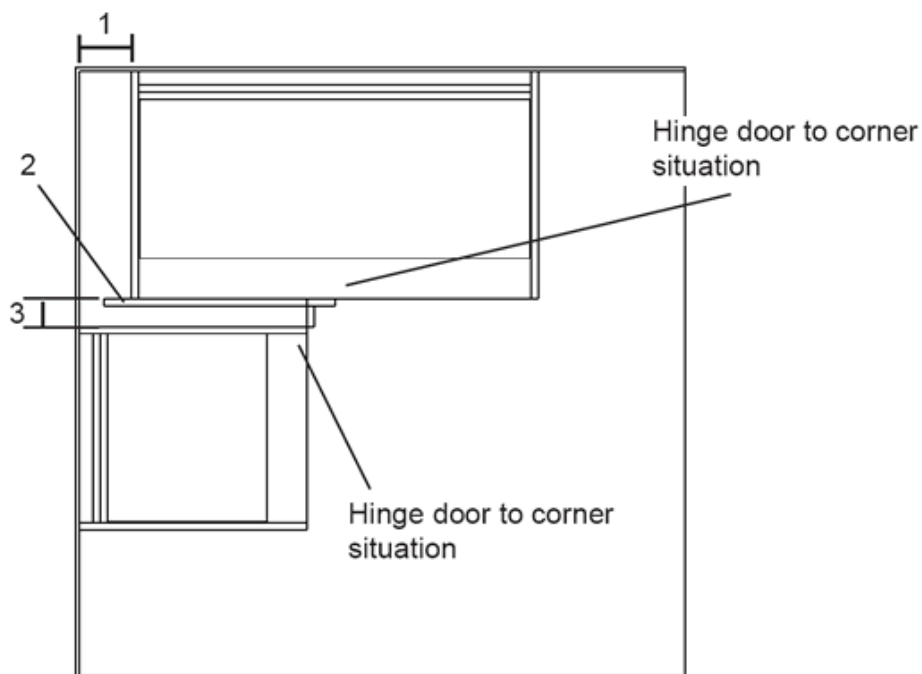

WALL CORNER ARRANGEMENTS

Note: This cabinet in itself is a variable planning dimension. Designed to be positioned in the corner of the room in such a way as to prevent the requirement of fillers between the other cabinets in the run

Note: This cabinet in itself is a variable planning dimension. Designed to be positioned in the corner of the room in such a way as to prevent the requirement of fillers between the other cabinets in the run

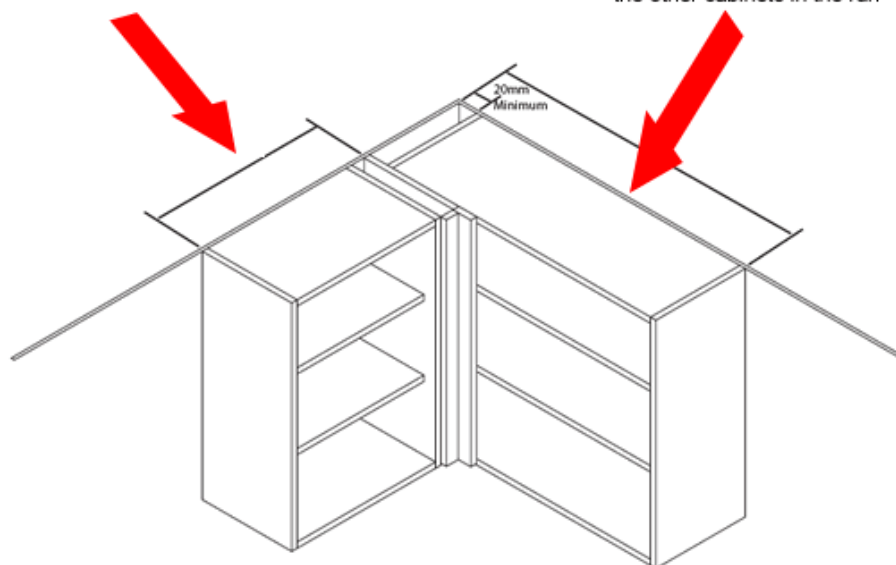

When fitting a wall corner arrangement please use the following instruction:

1. Position corner blank wall unit a minimum of 20mm from the wall allowing for depth of handle from door as selected.

2. If using a corner fillet remove and refit blanking panel to allow the fillet to be fitted in position as shown allowing for the door to fit correctly. Refit the blanking panel butting it up to the back edge of the fillet and trim if required

3. Fit the adjoining corner cabinet into position as shown allowing a minimum gap between the two cabinets (excluding the blanking panel) again for the handle selected

Note: Blanking panel on all corner walls is 300mm wide

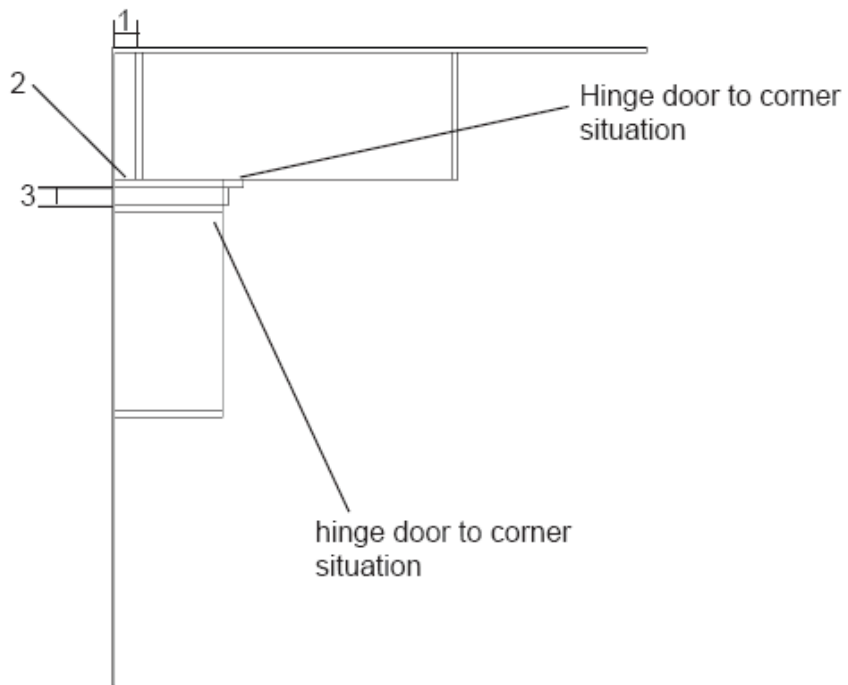

Please note:- Blanking panel
300 mm wide on all corner wall

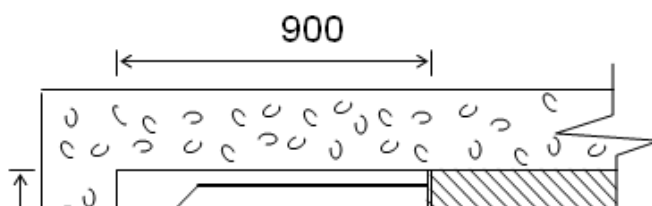

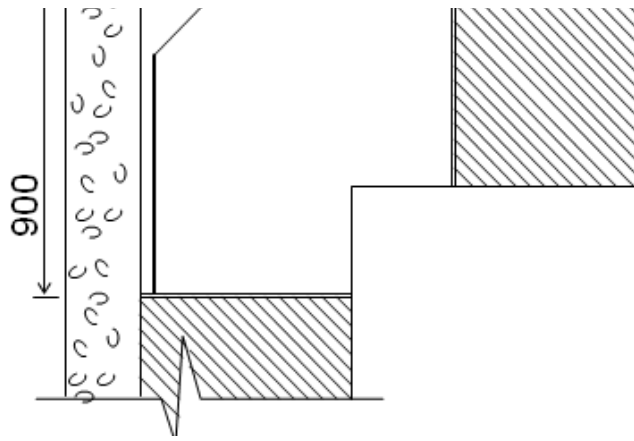

MAGIC CORNER

Slide out for corner base provides a new dimension to full utilisation of corner situations. Quality Chrome plated wire work from one of Europe's top manufacturers.



MAGIC CORNER

CHEF'S PANTRY

The Chef's pantry is suitable for units 900-1000mm wide and has a frame of 1214mm for use with 1245mm standard modular height doors. Silver epoxy frame and chrome baskets (20 frame baskets and 10 door baskets).



CHEF'S PANTRY